

Geese in the Middle

Cutting Instructions

Bag - (2) $2\frac{5}{8}$ " x $17\frac{1}{2}$ ", (2) $1\frac{3}{8}$ " x $17\frac{1}{2}$ ",
 (1) $4\frac{1}{2}$ " x $13\frac{1}{2}$ ", (4) $7\frac{1}{8}$ " x 8",
 (1) $1\frac{1}{4}$ " strip for binding, (8) handle
 tabs using template provided.

Contrast - (4) $7\frac{1}{8}$ " x $17\frac{1}{2}$ "

Make (2) copies of flying geese foundation and foundation piece. Sew $7\frac{1}{8}$ " x 8" to each side of geese (Diagram 1). Repeat for total (2). Sew contrast band to top and bottom Diagram 2). Repeat for total (2). Sew $2\frac{5}{8}$ " x $17\frac{1}{2}$ " to top and $1\frac{3}{8}$ " x $17\frac{1}{2}$ " to bottom (Diagram 3). Repeat for total (2). Sew bag units together with $4\frac{1}{2}$ " x $13\frac{1}{2}$ " bottom print between (Diagram 4).

Layer bag front with batting and back and quilt. Trim back and batting edges even with bag. Zig zag or serge edges.

Fold bag in half right sides together and stitch side seams (Diagram 5). Refold and stitch bottom to sides (Diagram 6).

Bind top edge. With right sides together sew handle tabs together leaving an opening to turn. Turn, press, and stitch opening shut. Repeat for total (4) finished tabs. Use tabs to attach handles to bag. Stitch a button to each tab (Diagram 7).

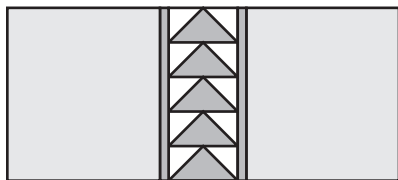

Diagram 1

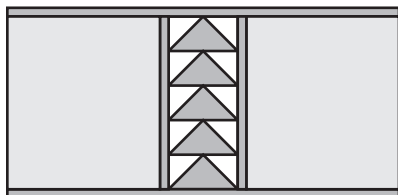

Diagram 2

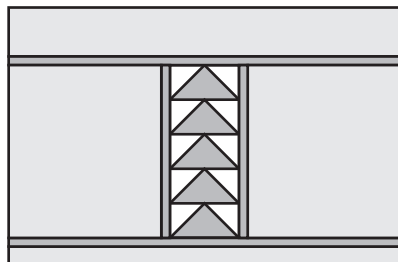

Diagram 3

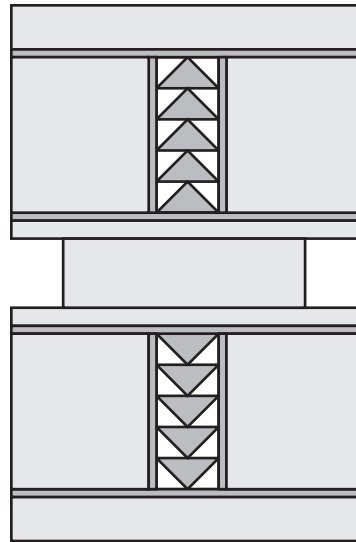

Diagram 4

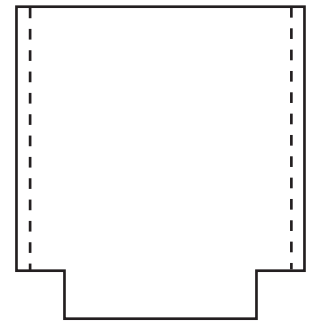

Diagram 5

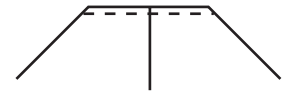

Diagram 6

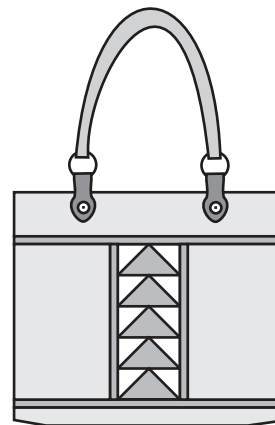
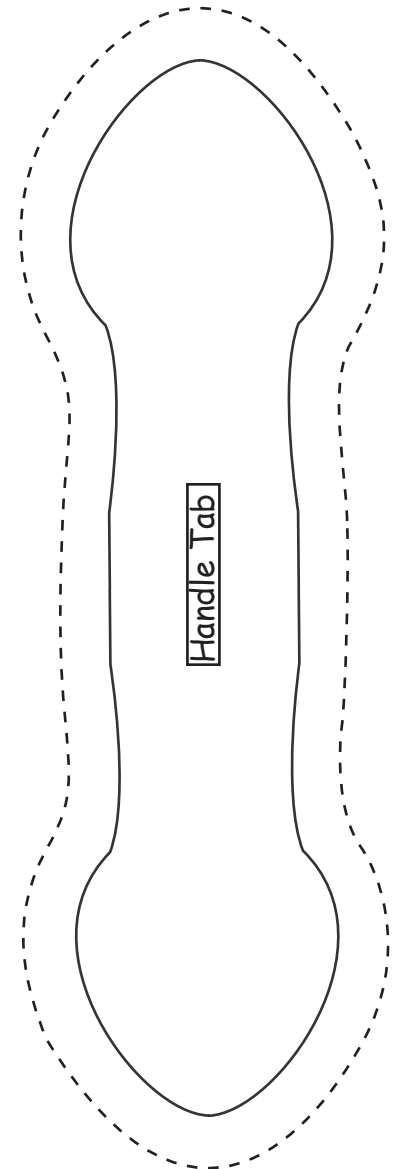
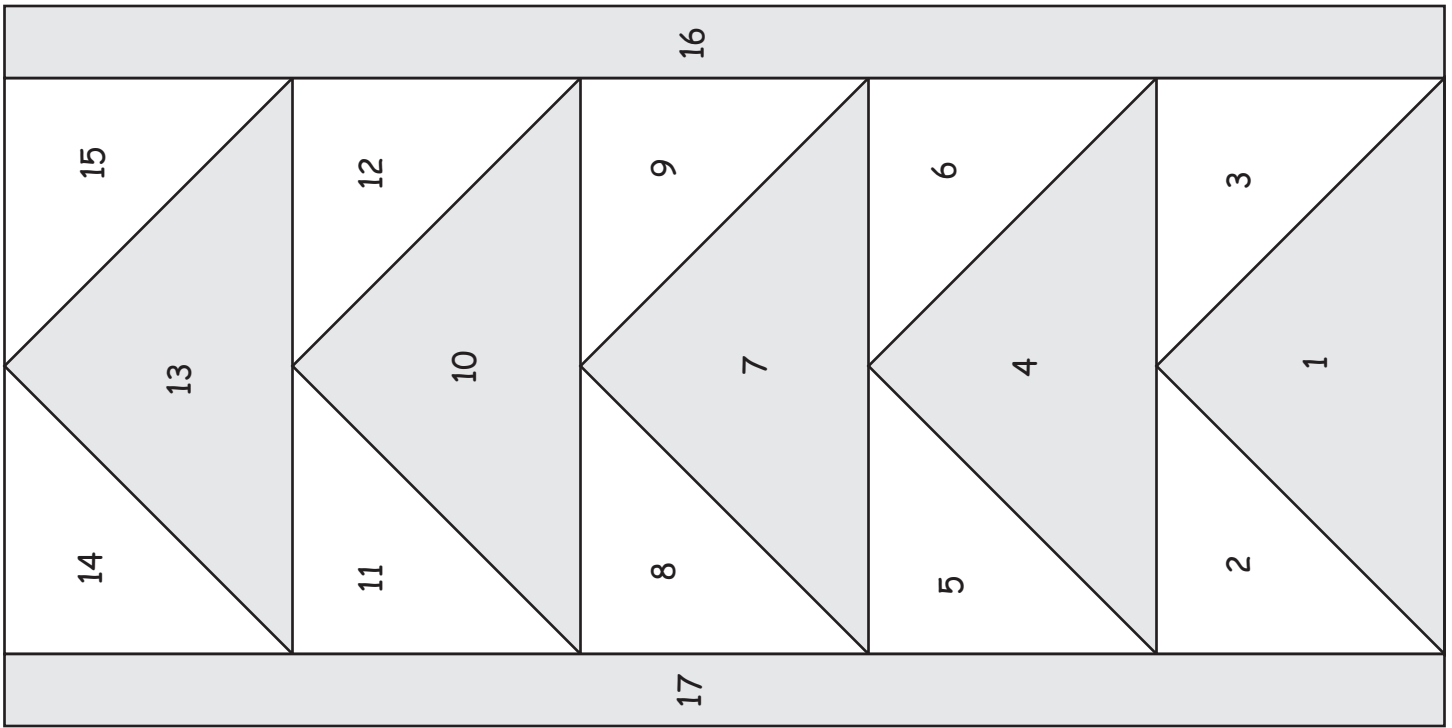

Diagram 7





Make 2 Copies

See all our designs by visiting us
on the web at:

www.scrapsofetimequilts.com
and
www.rgadesignquilts.com

Scraps of Time
2571 Longmeadow Dr.
West Jordan, UT 84084-5806
(801)964-1834
janet@scrapsofetimequilts.com

RGA Design
1141 Beecher Avenue
Brigham City, UT 84302
(435)723-7288
renae@rgadesignquilts.com



Geese in the Middle

